

SCALE 1/4"=1'-0"

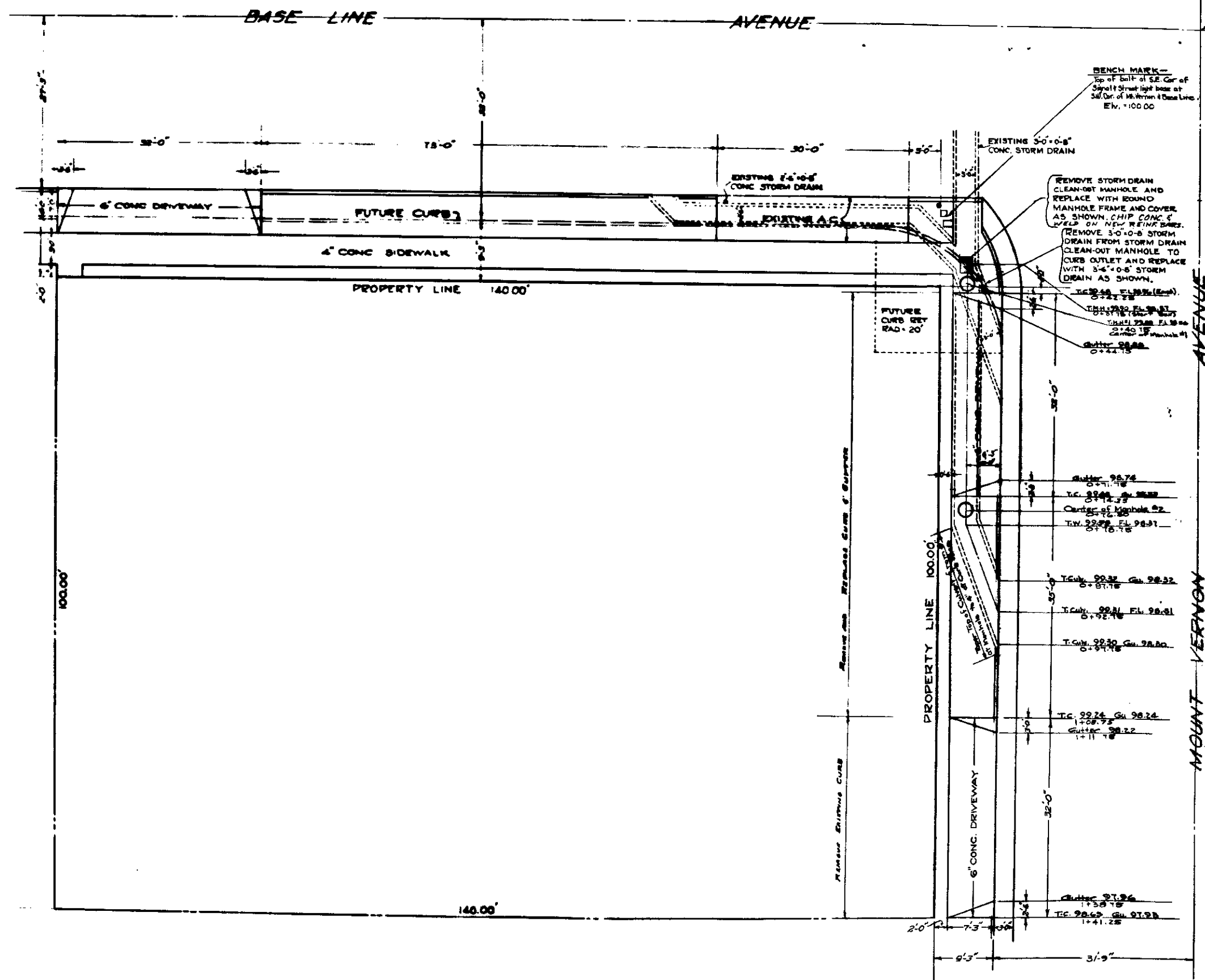

0+00  
E Base Line Ave

0+27.25

**NOTES:**  
 1. The old storm drain to be removed. Outlet back to Sta. 0+31.75. At the new storm drain connects to the old the steel of both structures are to be together to form one integral structure.  
 2. All work embed in these shall be done in conformity with provisions of Specifications No. 22.  
 3. Surface existing pavement to be replaced with 4" concrete as directed by Engineer.

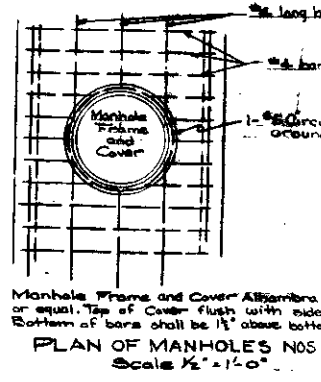
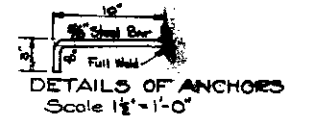
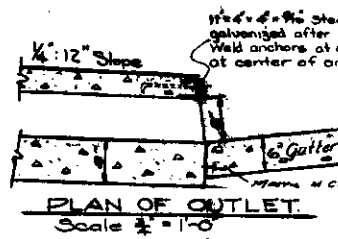
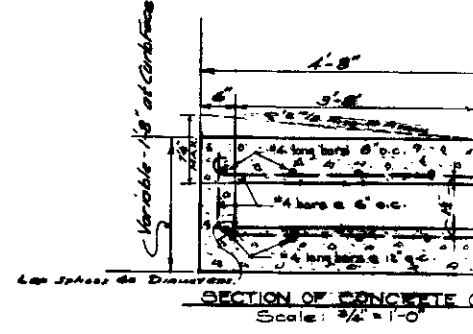

**NOTE:**  
 CONTRACTOR TO OBTAIN CITY PERMIT PRIOR TO CONSTRUCTION

DEPARTMENT OF ENGINEERING  
 CITY OF SAN BERNARDINO  
 IMPROVEMENT PLAN  
 SHOWING THE SOUTHWEST CORNER  
 BASE LINE AND MOUNT VERNON AVENUE

SCALE 1/4"=1'-0"

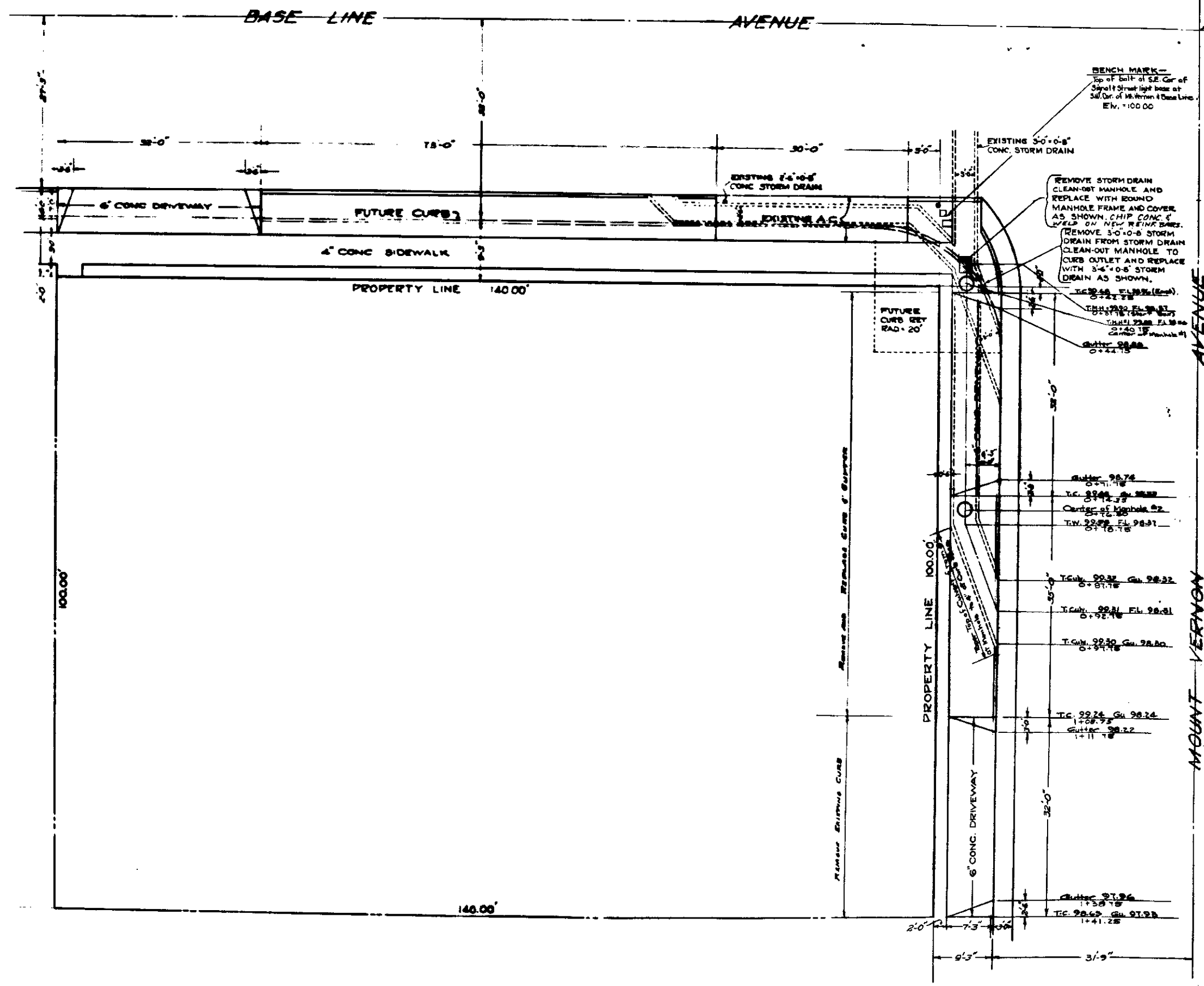

0+00  
E Base Line Ave

**NOTES:**  
 1. The old storm drain to be removed. Outlet back to Sta. 0+31.75. At the new storm drain connects to the old the steel of both structures are to be together to form one integral structure.  
 2. All work embed in these shall be done in conformity with provisions of Specifications No. 22.  
 3. Pavement existing pavement to be replaced with 4" concrete as directed by Engineer.

0+27.25

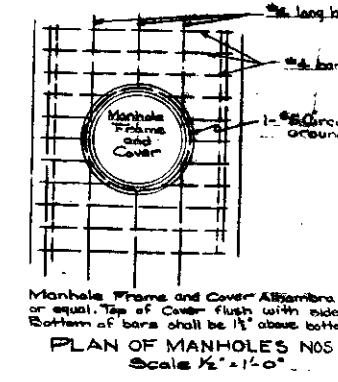
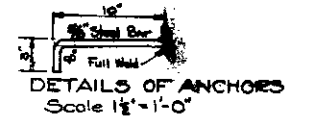
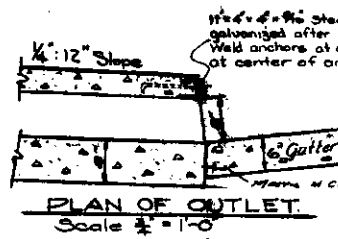
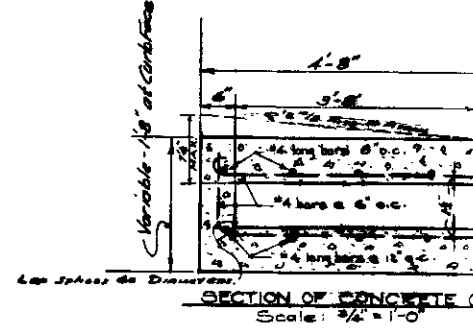

**NOTE:**  
 CONTRACTOR TO OBTAIN CITY PERMIT PRIOR TO CONSTRUCTION

DEPARTMENT OF ENGINEERING  
 CITY OF SAN BERNARDINO  
 IMPROVEMENT PLAN  
 SHOWING THE SOUTHWEST CORNER  
 BASE LINE AND MOUNT VERNON AVENUE